

It is right to open a psper rules

### Technologic Data & Function

- Max.breadth of door 700–1100mm
- Door weighs up to 35–60Kg
- Closing speed adjustable 180° –20°
- Locking strength adjustable 20° –0°
- Protect the Spray–paint&plastic rocker,avoid corruption
- Precision seal of fuel tank,avoid oil leak out.
- High quality cast of aluminium body,three folds shing paint, avoid oxidize Two hydraulic pressure control two closing speed
- ranges and the speed of deadlock,control all line of hydraulic pressure.
- High carbon steel gear spindle,rack.Treat with high frequency to make no distortion and nimble function.

### Notice the fixed type of door Closer

1. Bafore installing, don't turn the gear over 180 degrees,otherwise will damage the machine.
2. Adjust the gear by arm,the gear will be stoped when 180 degrees;Should turn back the originally position in time so that won't damage the machine when readjust.
3. Don't pull the door by habit as the door closer has the auto - close function.

#### Decide the switch and direction of the door

The bow here can fit for any open left or right door,please follow the indication to decide the direction of the door.

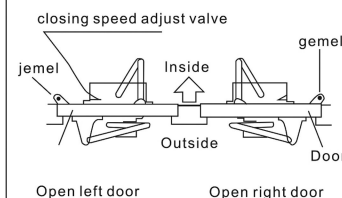

#### Closing speed adjustment

The first adjust screw control the first closing speed, the second adjust screw control the second closing speed. The adjust method is slow for clockwith, quick for anticlockwise.

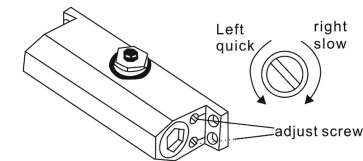
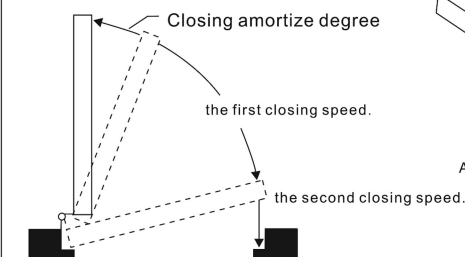

**Announcement:**  
The adjust scw can't circle out on flat surface of the machine otherwise the oil will leak immediately and it can't work up to snuff again.

B-B

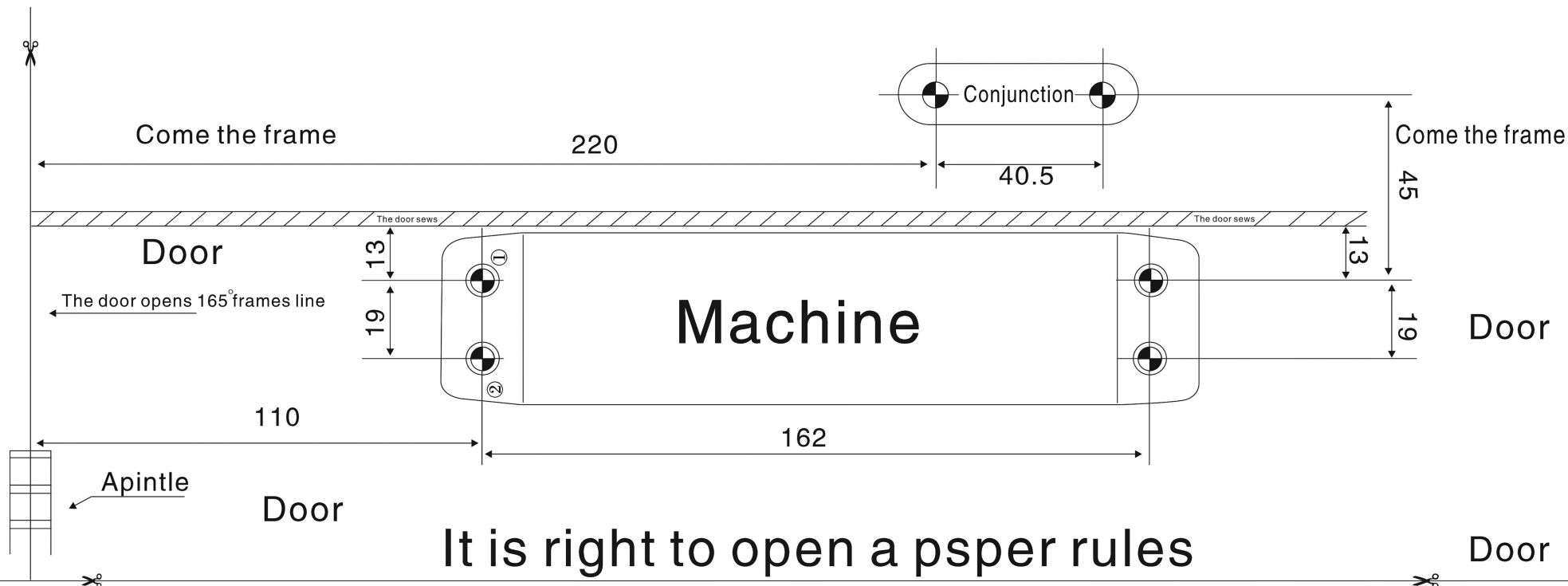

### Installation steps diagram

(The figures on picture above are the standard installation size,scissor along the line can be the installation model。)

### 1. Take installation size

Press according to the way on the paper in door and frames, use the adhesive tape fix with smoothly. Mark 4 holes in the door and 2 holes on the connection of the door frames. Use the aiguille drill hole for  $\Phi 5.0$ . Must drill again if use for Metal door.

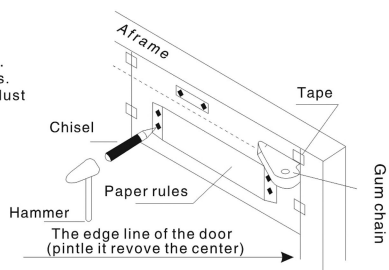

## 2. Intallation main body

Installation the machine in the  
Drill position and fix with 4 screws.

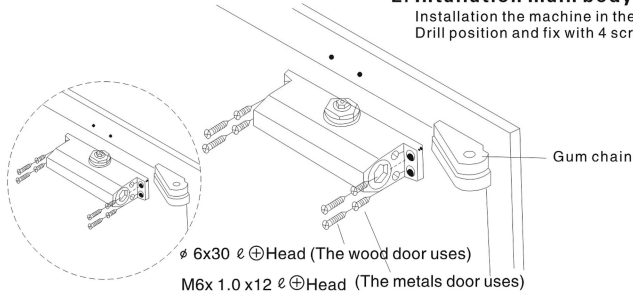

### 3. Fix conjunction

Installation connection in the drill position and fix with 2 screws

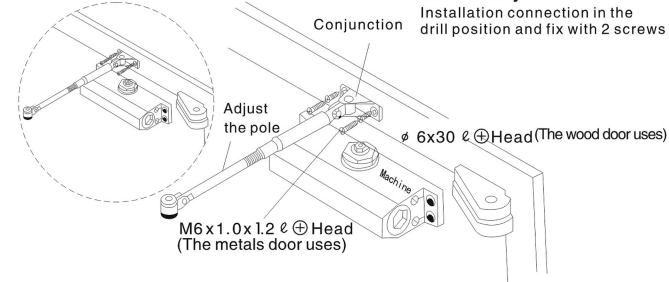

#### 4. Combine the Drive plank

Use the square in the drive plank install into the square trough and fix with screws.

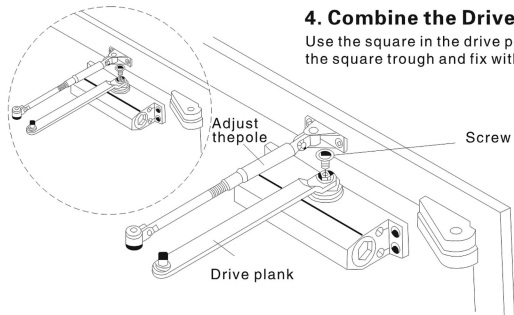

### 5. Combine the Drive plank and Adjust Pole

Use the adjust pole with door frame for 90° and fix smooth the drive plank and the pole.

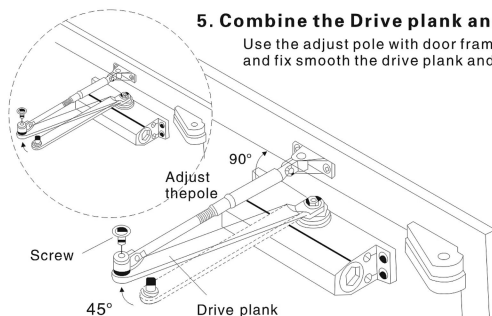

## 6. Finish installation

Cover the wheel gear cover, finish installation.

