

Smart Bluetooth-enabled ox-head lock

Intelligent Bluetooth Rimlock

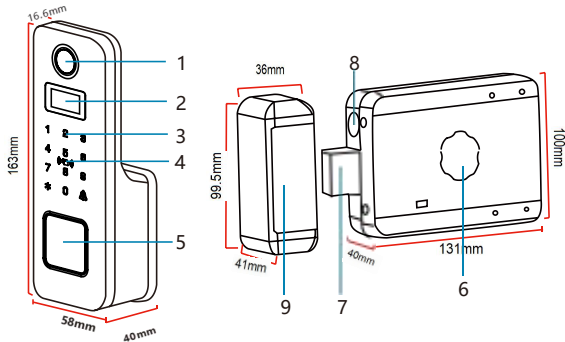

Dimension function diagram



- 1. Semiconductor fingerprint head
- 2. OLED display screen
- 3. Touch button
- 4. Card swiping area
- 5. Mechanical key hole
- 6. Indoor knob
- 7. Lock tongue
- 8. Door magnetic sensor
- 9. Secondary lock

Installation precautions

1. It is recommended to have a professional install the door (with a thickness of 30-60mm).
2. Do not squeeze the connecting wire during installation to avoid causing circuit faults.
3. During the installation and debugging process, please keep the door half open until the debugging is completed.
4. After installation, please test whether the fingerprint, password, RFID card, key, internal knob unlocking and other functions are normal.
5. If the door lock cannot be used normally, please check for improper installation or loose connection wires, and refer to the installation instructions for reinstallation.

Installation instructions for the main lock

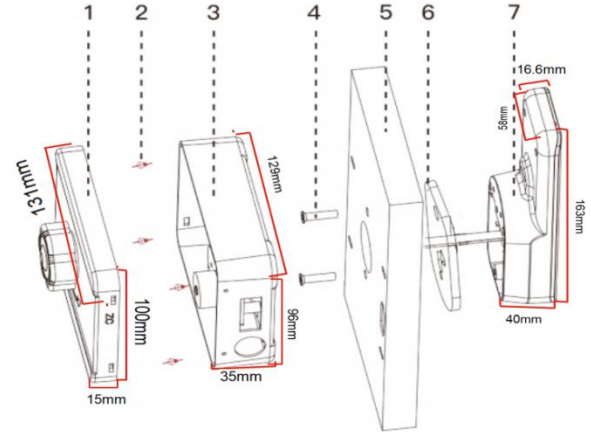

- 1. Rear lock cover
- 2. Lock body fastening screw
- 3. Rear lock body
- 4. Connecting column screw
- 5. Door panel
- 6. Silicone sheet (waterproof version)
- 7. front panel

Installation steps:

1. Make holes in the door panel according to the hole diagram.
2. Open the front panel lock cylinder cover and install the lock cylinder into the front panel.
3. Use connecting bolts as shown in the diagram to thread through the door panel and secure the front panel in place.
4. Secure the lock body to the door with screws, install the rear knob cover, and tighten the screws.

Installation Instructions for Lock Box

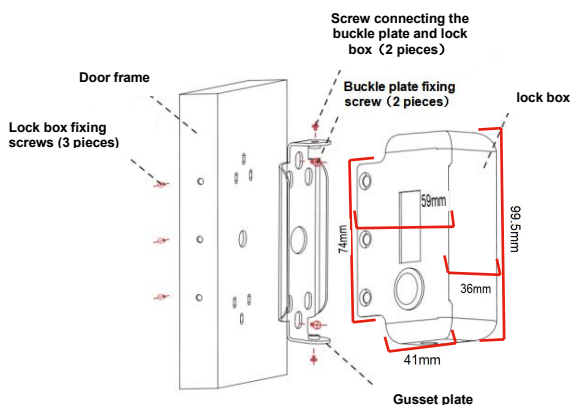

Installation steps:

1. Align with the main lock first, remove the lock buckle, and fix the buckle plate to the door frame with screws.
2. Install the lock box and secure it with the lock box fixing screws.
3. After installation, twist the back cover knob to test whether the lock body and locking box can maintain normal operation. If the knob switch lock is not smooth, please adjust the fixed position of the locking box or lock body.

Virtual password

Anti peeping password recognition system, supporting up to 20 virtual digit passwords (real passwords are 6 digits). When verifying the password, you can enter "fake password+real password+fake password

Code "is used for identification. For example, if the real password is 123456, you can enter "1689512345673228" and press the OK key to open the door.

1689512345673228 False Password True Password False Password

Delayed unlocking

Default 3-second lock back, the lock back time can be adjusted in the "Settings" of the APP

Restore factory settings

Press and hold the reset button on the back panel for more than 5 seconds, or use the Graffiti app to "reset to factory settings".



Technical Parameter

Unlocking methods: fingerprint, password, card, mechanical key, graffiti smart/smart life
Fingerprint type: semiconductor fingerprint sensor
Recognition speed: <0.6s
Recognition error: <0.001%
Fingerprint capacity: 100 pieces
Password capacity: 250 sets
Card capacity: 250 cards
Card type: RFID card
Working temperature: -20 °C -65 °C
Storage temperature: -40% -85%
Working power supply: 4 AA 5 alkaline dry batteries
Emergency power supply: USB TYPE-C interface

Graffiti Smart/Smart Life APP Management



Use WeChat to scan the QR code on the left or search for "Graffiti Smart/Smart Life" on WeChat.

1. Make sure the Bluetooth on your phone is turned on and click the "Add" button at the top. At this point, you should also lightly touch the smart lock panel to turn on the numeric keypad lights.
2. In Graffiti Smart/Smart Life, users can be managed, records can be read, locks can be turned on and off, temporary passwords can be set, firmware can be upgraded, sharing permissions and system settings can be performed.

More settings

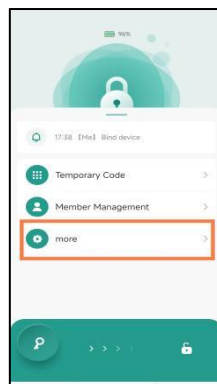

TemporaryPasswor

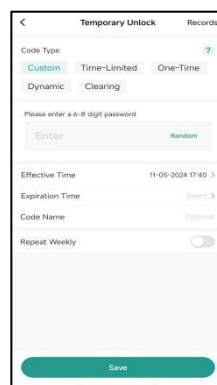
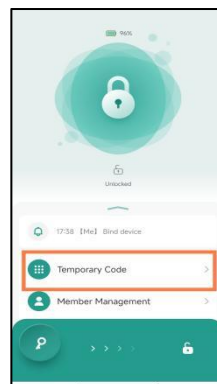

Operation Log

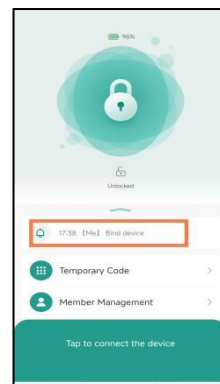

User registration/management: After adding the smart lock, it is necessary to register the administrator password. During the operation, the administrator password needs to be verified in multiple places.

Time setting: Synchronize the smart lock with the phone's time setting.

Record query: Unlock records can be exported for attendance statistics. Settings: Volume, delay, and other operations can be performed.

Share link: You can share this lock with friends for control.

Add device process

1. Scan the code to download the Smart Life/Graffiti Smart APP → 1+ # Open Bluetooth Radio → Wait for the device to pop up on the APP → Connect after the device pops up (note: if the device is not connected after 90 seconds of opening the broadcast, it will automatically turn off)

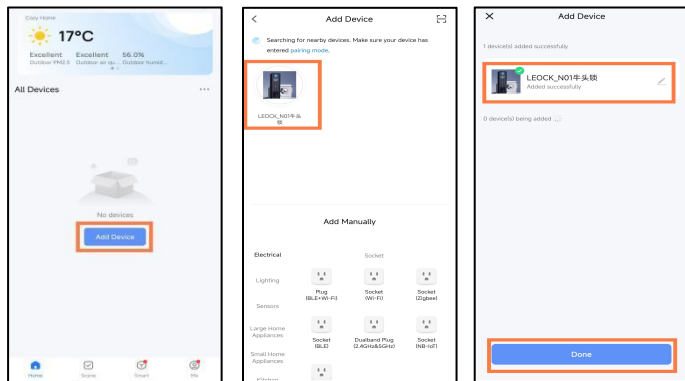

Thank you for purchasing this product!